

Lock nut | Polyamide

For polyamide cable glands | M12 - M63 | RAL7035 | RAL7001 | RAL 9005

Article:	Lock nut Polyamide
Brand:	Bimed
Material:	Polyamide 6 (30 % glass fiber reinforced)
Flammability:	HB according to UL94
Operating temperature:	-20°C to +100°C
Thread type:	Metric
Color:	RAL7035 RAL7001 RAL 9005



Description

- Locknuts in Polyamide – is an accessory used to secure the cable gland
- It is designed for use in non-threaded holes on enclosures

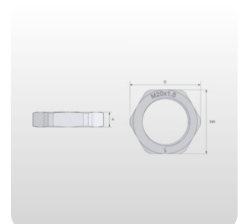
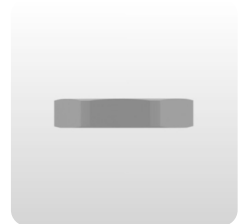

Article number

Art.No	Description	Size	Outer diameter	Height mm	Color	Unit	Pc
CBLMN-1S	Lock nut PA	M12x1.5	19.5	5	RAL7035	st	1
CBLMN-0S	Lock nut PA	M12x1.5	19.5	5	RAL7001	st	1
CBLMN-2S	Lock nut PA	M12x1.5	19.5	5	RAL9005	st	1
CBLMN-11	Lock nut PA	M16x1.5	24.2	5	RAL7035	st	1
CBLMN-01	Lock nut PA	M16x1.5	24.2	5	RAL7001	st	1
CBLMN-21	Lock nut PA	M16x1.5	24.2	5	RAL9005	st	1
CBLMN-12	Lock nut PA	M20x1.5	28.6	6	RAL7035	st	1
CBLMN-02	Lock nut PA	M20x1.5	28.6	6	RAL7001	st	1
CBLMN-22	Lock nut PA	M20x1.5	28.6	6	RAL9005	st	1
CBLMN-13	Lock nut PA	M25x1.5	35	6	RAL7035	st	1
CBLMN-03	Lock nut PA	M25x1.5	35	6	RAL7001	st	1
CBLMN-23	Lock nut PA	M25x1.5	35	6	RAL9005	st	1
CBLMN-14	Lock nut PA	M32x1.5	46.1	7	RAL7035	st	1
CBLMN-04	Lock nut PA	M32x1.5	46.1	7	RAL7001	st	1
CBLMN-24	Lock nut PA	M32x1.5	46.1	7	RAL9005	st	1
CBLMN-15	Lock nut PA	M40x1.5	55.3	7	RAL7035	st	1
CBLMN-05	Lock nut PA	M40x1.5	55.3	7	RAL7001	st	1
CBLMN-25	Lock nut PA	M40x1.5	55.3	7	RAL9005	st	1
CBLMN-16	Lock nut PA	M50x1.5	66.1	8	RAL7035	st	1
CBLMN-06	Lock nut PA	M50x1.5	66.1	8	RAL7001	st	1

Article number

CBLMN-26	Lock nut PA	M50x1.5	66.1	8	RAL9005	st	1
CBLMN-17	Lock nut PA	M63x1.5	82.5	8	RAL7035	st	1
CBLMN-07	Lock nut PA	M63x1.5	82.5	8	RAL7001	st	1
CBLMN-27	Lock nut PA	M63x1.5	82.5	8	RAL9005	st	1